

should be reliable at this distance but environment and location of both the transmitter and receiver will affect the range. If the transmitter is stowed well out of sight, it may be necessary to remove it from its mounting and hold near the windshield. Try different locations and positions. If operation is still unsatisfactory, the problem may be isolated by:

1. Checking the door operator. If the door will not open when the wall button is pressed, the problem is likely to be the operator. If the door will open by pressing the wall button, but not when the radio control button is pressed, the problem is probably in the radios.
2. Replacing the transmitter battery. If, after performing the above operational checks, the controls still do not function, they should be returned to your dealer for repair or replacement.

CAUTION: *Any changes or modifications in intentional or unintentional radiators which are not expressly approved by LINEAR CORPORATION could void the user's authority to operate this equipment. This applies to intentional and unintentional radiators certified per part 15 of the F.C.C. rules and regulations.*

This device complies with FCC Part 15 and Industry Canada Rules and Regulations. Operation is subject to the following two conditions: (1) This device may not cause harmful interference, and (2) This device must accept any interference received, including interference that may cause undesired operation.

LINEAR CORPORATION

2055 Corte del Nogal
Carlsbad, CA 92009



Micro-Code
BY *Linear*

INSTALLATION INSTRUCTIONS

MICRO-TRANSMITTER MODEL 1082

Congratulations! You have just purchased a Micro-Code Digital Transmitter, which we believe to be the finest product of its kind on the market. With a little care this transmitter should provide you with many years of excellent service. Please take a moment to read the following instructions and you will find that setting your new transmitter will be quite an easy matter.

ACCESSING THE CODE SWITCH AND BATTERY COMPARTMENT

The model 1082 Micro-Transmitter case is composed of 2 halves which can be opened by inserting a small coin in the slot provided. A twisting motion of the coin will cause the 2 halves to separate. Once opened you will have access to both the code setting switch and the battery compartment. (See Diagram #1)

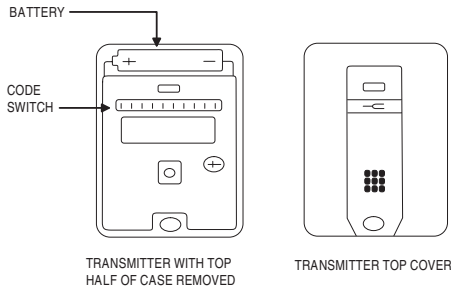

DIAGRAM #1

SELECTING A CODE

Set both transmitter and receiver switches to the code of your choice, being sure both are set the same since a different setting of just one switch will prevent operation. The digital code is determined by the position of 10 small switches numbered 1 through 10 located in the receiver and transmitter. Any combination of "on" or "off" positions can be selected by using a pencil or ball point pen. (Note: The switches are in the "on" position when the switch is depressed toward the number.) See diagram # 2.



CODE SWITCH
DIAGRAM #2

Once the codes have been set, check operation and reassemble the transmitter case.

MICRO-TRANSMITTER INSTALLATION

This transmitter is completely self contained, including battery and can be operated while held in hand or while mounted in the car. It is supplied with "hook and loop" fabric for easy mounting or it may be added to your key chain using the slot provided.

TRANSMITTER BATTERY REPLACEMENT

Replacement battery - 12 volt alkaline lighter battery (Eveready A 23 or equivalent)

The transmitter battery can be checked or changed by opening the case using a small coin in the slot provided. A twisting motion of the coin will separate the case halves and provide access to the battery compartment. Simply slide out the old battery and slide in the new, remembering to observe the battery polarity molded on the case in the bottom of the battery compartment.

Note that if the red L.E.D. on your transmitter fails to light, you most likely have a weak or dead battery and it should be replaced. (see diagram #1)

OPERATIONAL CHECK

To check operation, move back a reasonable distance (about 50 ft.) and press the transmitter button. Operation